



INSTRUCTION BULLETIN

No. 9012954
Machine: T17
Published: 12-2014
Rev. 00

NOTE: DO NOT DISCARD the Parts List from the Instruction Bulletin. Place the Parts List in the appropriate place in the machine manual for future reference. Retaining the Parts List will make it easier to reorder individual parts and will save the cost of ordering an entire kit.

NOTE: Numbers in parenthesis () are reference numbers for parts listed in Bill of Materials.

Installation instructions for **kit number 9020223**

SYNOPSIS:

This kit contains the parts needed to replace pod panel on T17 scrubbers.
Please follow step-by-step instructions.

SPECIAL TOOLS / CONSIDERATIONS: NONE

(Estimated time to complete: 45 minutes)



PROTECT THE ENVIRONMENT

Please dispose of packaging materials, used machine components such as batteries and fluids in an environmentally safe way according to local waste disposal regulations.

Always remember to recycle.

PREPARATION:

FOR SAFETY: Before leaving or servicing machine, stop on level surface, turn off machine, and remove key.

1. Disconnect the battery cable from the machine.

 **WARNING: Always disconnect battery cables from machine before working on electrical components.**

2. Remove the access panel from the machine. Set the access panel and all hardware aside. (Fig. 1)

INSTALLATION:

1. Loosen both set screws securing the control pod assembly shaft inside the bearing plate. (Fig. 1)
2. Disconnect the main wire harness from the control pod assembly. (Fig. 1)
3. Pull the control pod assembly from the steering wheel assembly. (Fig. 1)

4. Remove the thrust washer from the control pod assembly shaft and slide the thrust washer onto the new control pod assembly (1) shaft. (Fig. 1)
5. Install the control pod assembly (1) into the steering wheel assembly. (Fig. 1)
6. Connect the main wire harness to the control pod assembly (1). (Fig. 1)
7. Orient the control pod assembly (1) so it is correctly positioned on the machine.
8. Tighten the set screws to secure the control pod assembly (1) in the steering wheel assembly. (Fig. 1)
9. Reconnect the battery cable to the machine.
10. Start and test the machine. Operate the control pod controls to ensure they are functioning. Ensure the LCD display is functioning.

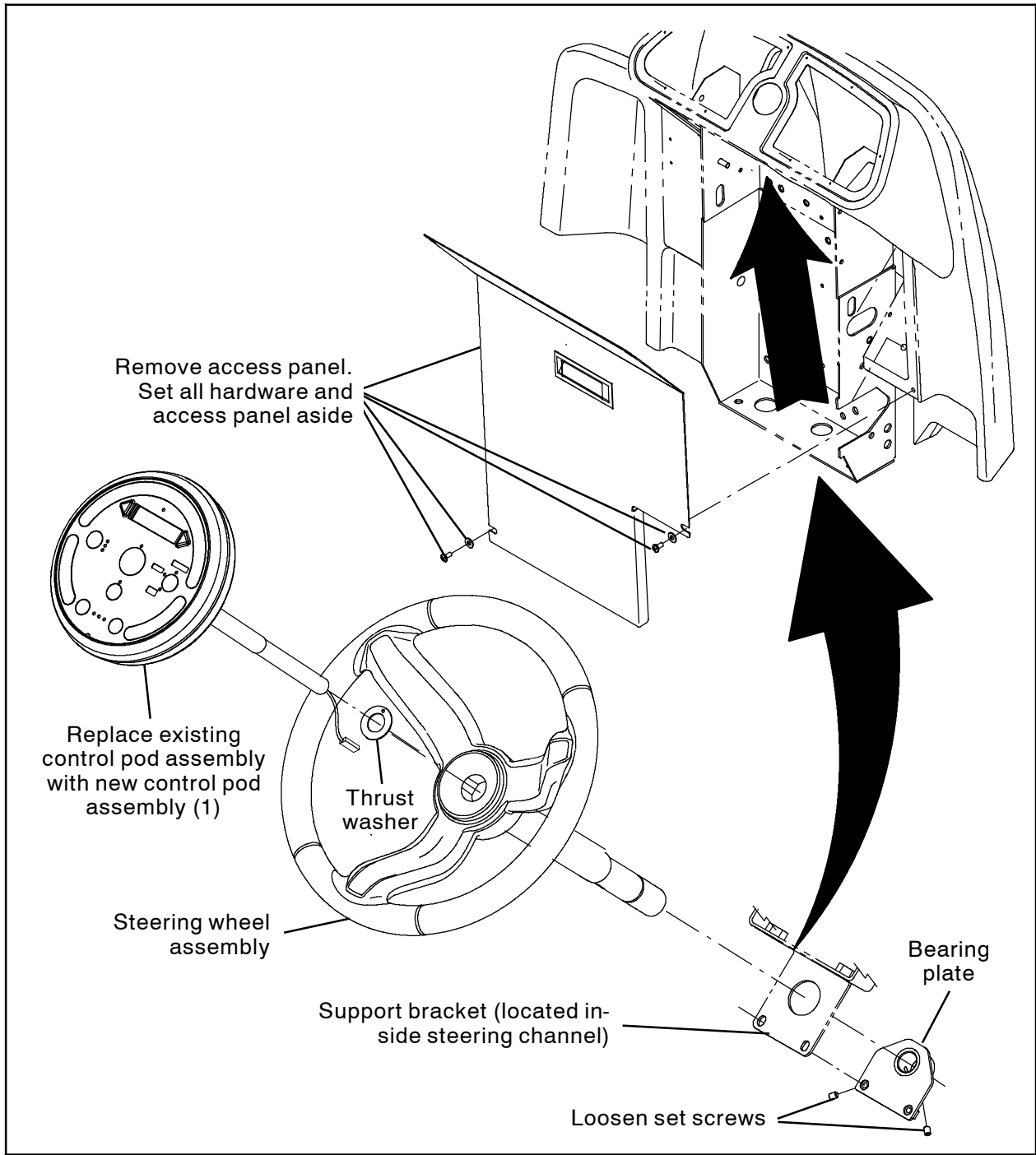

FIG. 1

Bill of Materials For Panel Kit, Pod, Afmkt [T17] - 9020223

Ref.	Tennant Part No.	Description	Qty.
▽	9020223	Panel Kit, Pod, Afmkt [T17]	1
▲	1 9020093	Cntrl Panel Kit, Pod w/Pkg	1

TENNANT COMPANY
P. O. Box 1452
Minneapolis, MN 55440-1452